

Organic Wall Panels
Elevation 1:50

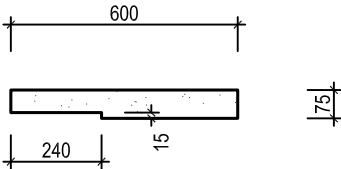

Groove Detail
Section 1:20

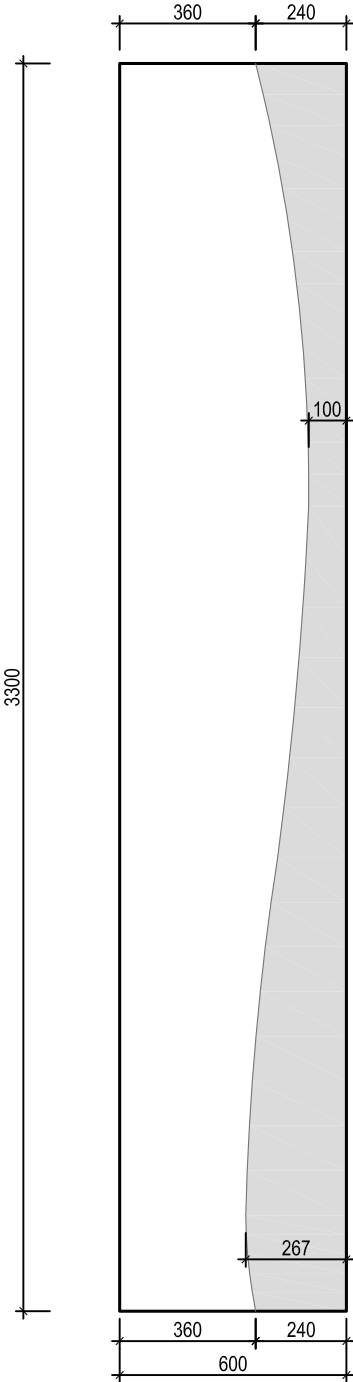

Organic P1 Wall Panel
Elevation 1:20

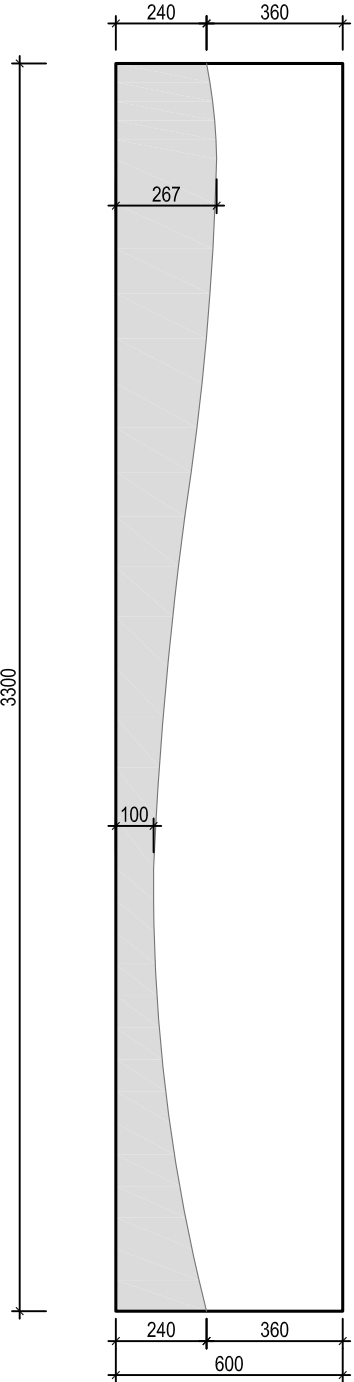

Organic P2 Wall Panel
Elevation 1:20



CSR BUILDING PRODUCTS LTD
Head Office: Triniti 3, 39 DELHI RD, NORTH RYDE NSW 2113
LOCKED BAG 1345, NORTH RYDE BC NSW 1670
A.B.N. 55 008 631 356 Ph: 1300 369 448
www.hebel.com.au

hebel®

The better way to build

CSR Building Products Limited

A.B.N. 55 008 631 356

112 Wisemans Ferry Road

Somersby, NSW 2500

Phone: (02) 4340 3380

Fax: (02) 4340 3300

TITLE PowerPattern™ ORGANIC DESIGN 3300 "INFILL"			
SCALE 1:50 @ A3	SHEET SIZE A3	DRAWN CW	DATE 22.02.19
	SHEET NO. 1 of 1	CHECK GO	REVISION A